

## 旋翼式同心钻具

工作步骤:

- 1.启动钻具，旋翼像四周打开，形成扩孔范围，从而带动管靴和跟管往下跟进。
- 2.到达基岩时，将钻具反转，旋翼收拢后，可将钻具从孔底提出。
- 3.进行下一步施工

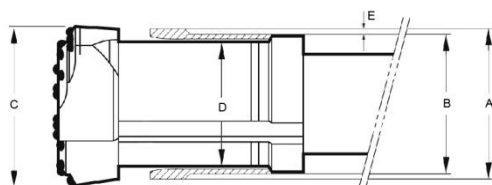
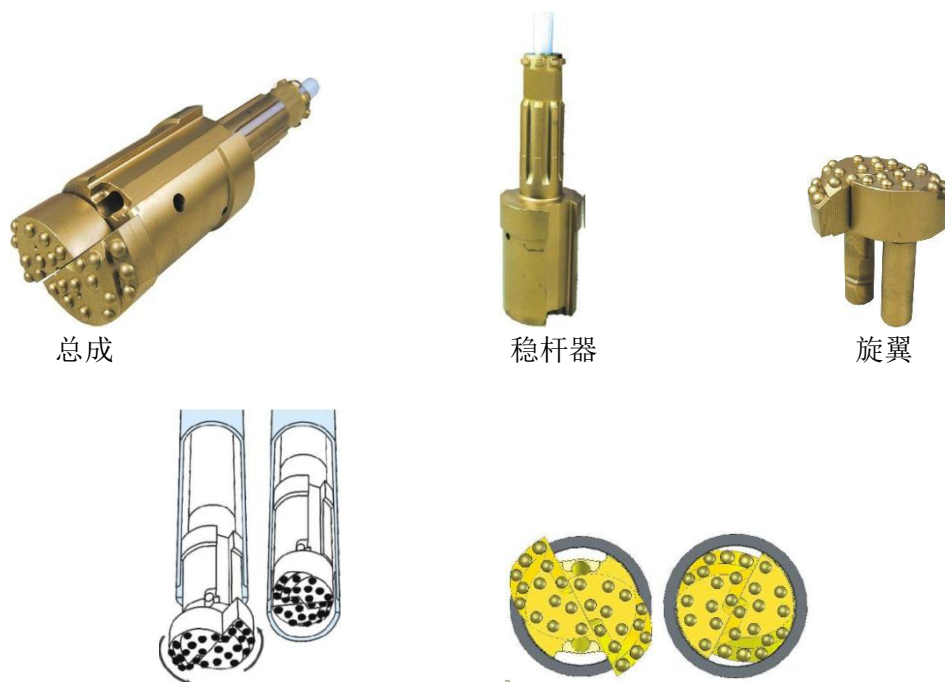

	A	E	C	D		
编码	跟管 外径	跟管壁厚	扩孔尺寸	管靴内孔最 小直径	所配冲击器	所配钻杆
KCC125	114 mm (4.5")	11-13mm (0.43")-(0.51")	125 mm (4.92")	93 mm (3.66")	DHD 350 COP 32/34	60 mm (2.36")
KCC152	140 mm (5.5")	13-16mm (0.51")-(0.63")	152 mm (6")	113 mm (4.45")	DHD 340 QL 40, SD-4	76 mm (3")
KCC150	146 mm (5.75")	14-19 mm (0.55")-(0.75")	154 mm (6.06")	115 mm (4.52")	DHD 340 QL 40, SD-4	76 mm (3")
KCC185	168 mm (6.6")	13-19 mm (.51")-(0.75")	184 mm (7.25")	138 mm (5.43")	DHD 350 QL 50, SD-5	76, 89 mm (3"), (3.5")
KCC190	178 mm (7")	13-19 mm (0.51")-(0.75")	194 mm (7.6")	148 mm (5.8")	DHD350/360 QL50/60,SD5/6	76, 89 mm (3"), (3.5")
KCC205	193 mm (7.6")	13-20 mm (0.51")-(0.78")	206 mm (8.11")	164 mm (6.45")	DHD360 QL 60 /SD-6	114 mm (4.5")
KCC230	219 mm (8.62")	13-20 mm (0.51")-(0.78")	234 mm (9.2")	185 mm (7.28")	DHD360 QL 60, SD-6	114 mm (4.5")
KCC275	244 mm (9.6")	13-20 mm (0.51")-(0.78")	273 mm (10.75")	219 mm (8.62")	DHD380 QL-80, SD-8	114 mm (4.5")